

NON-MARKING PROTECTIVE BUMPERS

PROTECTS WALLS AND EQUIPMENT



C-1676

C-1676 Corner Bumpers
Made especially for use with C-567 Strip Bumper to give a uniform continuous effect all around the equipment.



C-833

C-833 Corner Bumper
Made to give adequate protection to all surfaces that may be contacted, such as doors, door facings, walls, furniture, and other equipment. Easily attached by using self-tapping sheet metal screws.

C-813 Donut Bumpers
Commonly installed on the ends of tubular handles to give needed protection in manipulation of equipment .
Note: steel insert around mounting hole. Attached to wood with wood screws or to metal with rivets, bolts, or metal screws.



C-813

Model C-567 Strip Bumper
A flat based rubber strip bumper designed for installation on either metal or wood surfaces. This model is easily applied and does not require a special channel.

(MI-500- Flat Bar Metal Inserts 1/8" x 1/2" for C-567, ordered separately, subject to cutting charge).

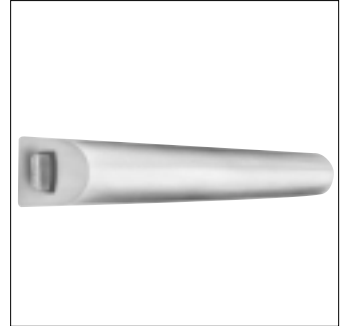

C-567

FLOOR LOCKS

SECURES LOAD IN POSITION



634

HOW TO OPERATE FLOOR LOCKS

Press down to lock. Press down to release. Double non-slip pedals.

Simply press down on larger pedal to set positive lock. (This moves second pedal into top or up position.)

Press down on release pedal and spring quickly returns lock to non-operating position. Both pedals are out in front for safety and ease of operation.

INSTALLATION RECOMMENDATIONS FOR CASTER & FLOOR LOCK.

It is important to select a Caster with an overall height to permit the floor lock to clear the floor in retracted position. The clearance between floor and floor lock rubber pad should be minimal in order to use as much pressure from spring locking device. This will ensure better holding pressure from lock.

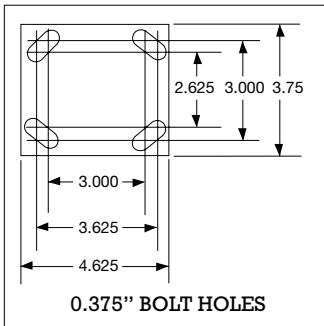

No. 31 Top Plate

MODEL NUMBER	EXTENDED HEIGHT	RETRACTED HEIGHT
558	5-5/8"	5"
614	6-1/4"	5-5/8"
634	6-3/4"	6-1/8"
734	7-3/4"	7"